

\$850,000 - 500 Parkins Avenue, Rural Lac Ste. Anne County

MLS® #E4382358

\$850,000

0 Bedroom, 0.00 Bathroom,
Land Commercial on 0.00 Acres

None, Rural Lac Ste. Anne County, AB

Discover 44+/- acres of boundless outdoor opportunities nestled in the Summer Village of Ross Haven! Formerly a golf course. Embrace lakeside living as you envision your dream home, just steps away from the shores of Lac Ste Anne. Offering year-round recreational outdoor activities conveniently situated, just 30 minutes to Stony Plain/Spruce Grove and 45 minutes to Edmonton. Experience the perfect blend of tranquility and accessibility on your own piece of lakeside paradise. Water wells on property.

Essential Information

MLS® #	E4382358
Price	\$850,000
Bathrooms	0.00
Acres	0.00
Type	Land Commercial
Status	Active

Community Information

Address	500 Parkins Avenue
Area	Rural Lac Ste. Anne County
Subdivision	None
City	Rural Lac Ste. Anne County

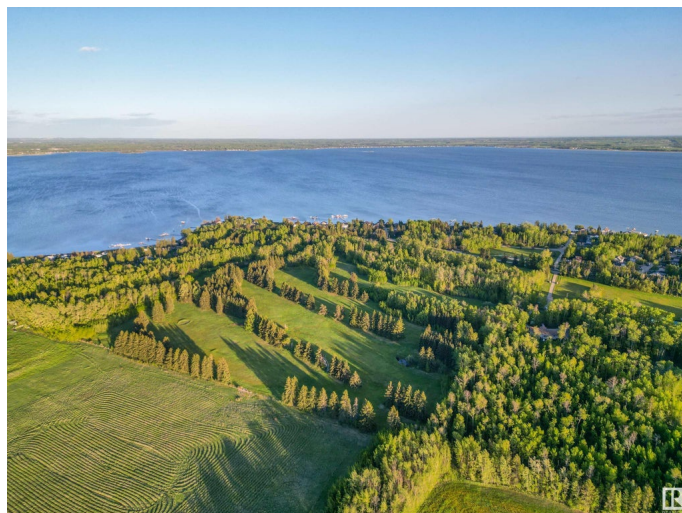
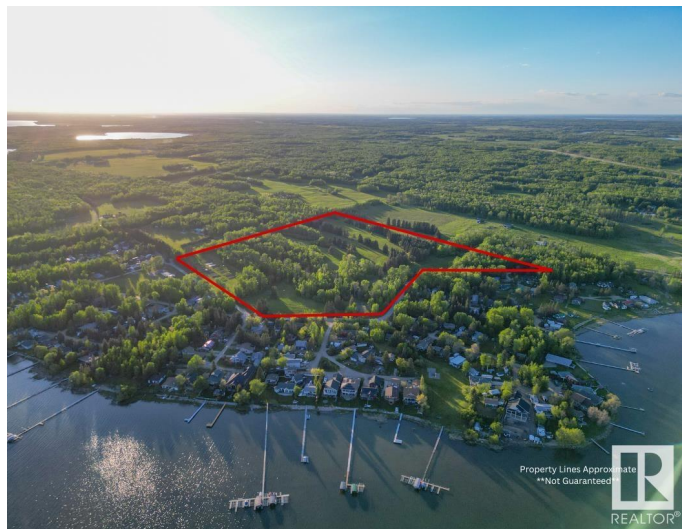

County	ALBERTA
Province	AB
Postal Code	T0E 1A0

Additional Information

Date Listed	April 16th, 2024
Days on Market	426
Zoning	Zone 70

DATA IS DEEMED RELIABLE BUT IS NOT GUARANTEED ACCURATE BY THE REALTORS® ASSOCIATION OF EDMONTON. COPYRIGHT 2025 BY THE REALTORS® ASSOCIATION OF EDMONTON. ALL RIGHTS RESERVED.Trademarks are owned or controlled by the Canadian Real Estate Association (CREA) and identify real estate professionals who are members of CREA (REALTOR®, REALTORS®) and/or the quality of services they provide (MLS®, Multiple Listing Service®)

Listing information last updated on June 16th, 2025 at 2:17am MDT