

\$399,900 - 132 Richfield Rd Nw, Edmonton

MLS® #E4432152

\$399,900

3 Bedroom, 3.00 Bathroom, 1,199 sqft
Single Family on 0.16 Acres

Richfield, Edmonton, Alberta

This property could be a great purchase for the right buyer. Although it requires updating, as it is mostly in original condition , yet is located on large, 7,148 sq.ft (664.06 sq.m.) lot backing walking path with steps to Bhullar Park. Fantastic, double detached, oversized (23.3' by 23.3' interior) garage was built with permit in 2002. Main floor offers living room with wood burning fire place, kitchen, 3 bedrooms and 1 and a half baths. Basement is fully developed and has large windows. Located close to schools, transportation and good proximity to Whitemud Drive and Anthony Henday highway. Property is being sold in as-is condition. Make a move and build some sweat equity! (id:36535)

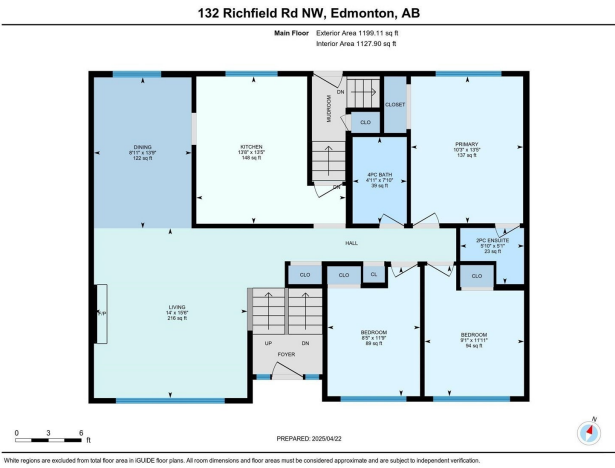

Built in 1973

Essential Information

Listing #	E4432152
Price	\$399,900
Bedrooms	3
Bathrooms	3.00
Half Baths	1
Square Footage	1,199
Acres	0.16
Year Built	1973
Type	Single Family
Sub-Type	Freehold
Style	Bi-level

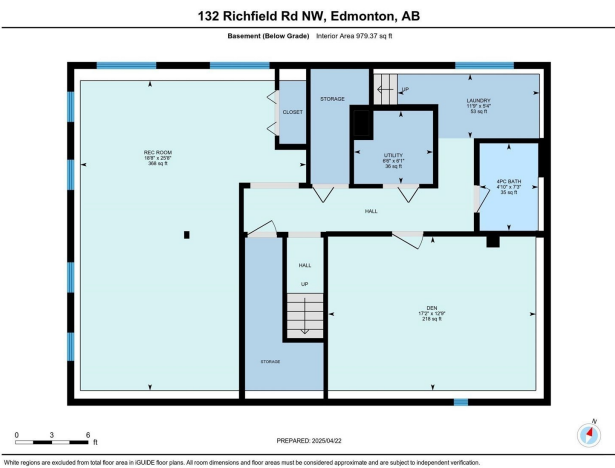

Community Information

Address	132 Richfield Rd Nw
Subdivision	Richfield
City	Edmonton
Province	Alberta
Postal Code	T6K0A2

Amenities

Amenities	Schools, Shopping
Features	See remarks, Flat site
Parking	Detached Garage, Oversize
# of Garages	1

Interior

Appliances	Dryer, Garage door opener, Refrigerator, Stove, Washer		
Heating	Forced air		
Has Basement	Yes		
Basement Type	Full (Finished)		
Basement Development	Finished		

Listing Details

Listing Office	Courtesy Of Teresa Koziel Of Homes & Gardens Real Estate Limited
----------------	--

Powered by:



The trademarks MLS®, Multiple Listing Service® and the associated logos are owned by The Canadian Real Estate Association (CREA) and identify the quality of services provided by real estate professionals who are members of CREA. REALTOR®. Member of CREA and more.

Listing information last updated on May 1st, 2025 at 10:32pm MDT