

Courtesy Of Natalie C Kelly Of RE/MAX Bonnyville Realty

\$139,900 - 61315 41 Highway, Rural Bonnyville M.D.

MLS® #E4450228

\$139,900

0 Bedroom, 0.00 Bathroom,
Land Commercial on 0.00 Acres

None, Rural Bonnyville M.D., AB

Prime Industrial Opportunity on Highway 41!
Build Your Business Here! This 1.31 acre industrial lot is ideally situated just 1.6 km north of Bonnyville town limits, offering excellent visibility. Located near the airport and established industrial subdivisions, this property provides a strategic location for a wide range of commercial and industrial uses. The lot is fully fenced and gravelled with utilities nearby, making it ready for development. With high traffic exposure and convenient access, this is the perfect spot to position your business for success. Explore The Potential Today!

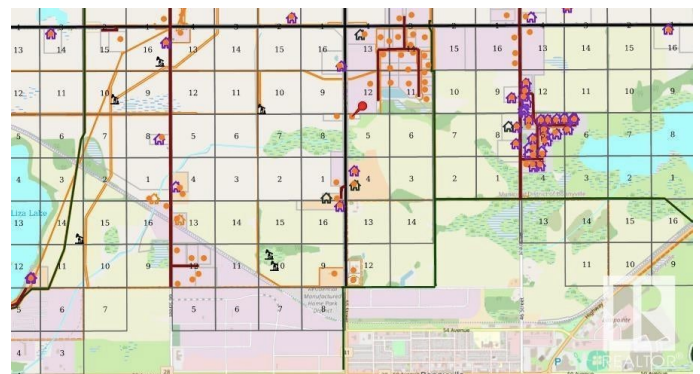

Essential Information

MLS® #	E4450228
Price	\$139,900
Bathrooms	0.00
Acres	0.00
Type	Land Commercial
Status	Active

Community Information

Address	61315 41 Highway
Area	Rural Bonnyville M.D.
Subdivision	None
City	Rural Bonnyville M.D.

County ALBERTA
Province AB
Postal Code T9N 2J6

Additional Information

Date Listed July 28th, 2025
Days on Market 5
Zoning Zone 60

DATA IS DEEMED RELIABLE BUT IS NOT GUARANTEED ACCURATE BY THE REALTORS® ASSOCIATION OF EDMONTON. COPYRIGHT 2025 BY THE REALTORS® ASSOCIATION OF EDMONTON. ALL RIGHTS RESERVED. Trademarks are owned or controlled by the Canadian Real Estate Association (CREA) and identify real estate professionals who are members of CREA (REALTOR®, REALTORS®) and/or the quality of services they provide (MLS®, Multiple Listing Service®)

Listing information last updated on August 2nd, 2025 at 10:17am MDT